

# Farm for Sale

Busey Farm Brokerage

## H.M. Owen Heirs Farm — Christian County

162.1 taxable acres in Buckhart Township



### Location

This farm is located 5.0 miles northwest of Stonington, Illinois, in the northeast corner of Buckhart township.

### Legal Description

The northwest quarter NW 1/4 of Section 1, Township 14 North, Range 2 West of the Third Principal Meridian, except for one acre in the northeast corner thereof for church purposes, in Christian County, Illinois.

### Listing Price

162.1 Acres @ \$ 14,000 /acre \$2,269,400.00

### Lease/Possession

The lease for this farm is currently open for 2022.

### Contact Information



**Seth Melton, Listing Broker** 217-425-4541 Office  
seth.melton@busey.com 217-250-5536 Cell

**Alex Rhoda, Broker** 217-425-8821  
**Corey Zelhart, Broker** 217-425-8245  
**Steve Myers, Managing Broker** 217-425-8340

[busey.com](http://busey.com)

259 E. South Park—Decatur, IL 62523  
Phone: 217-425-8340—Fax 217-362-2724

**Disclaimer:** The information contained in this brochure is considered accurate. It is subject to verification and no liability for errors or omissions is assumed. There are no warranties, expressed or implied, as to the information herein contained, and it is recommended that an independent inspection of the property be made by all buyers.  
**Agency:** Busey Farm Brokerage, a division of Busey Bank, its agents and representatives, are agents of the Seller

### Christian County FSA Data

Farm # 9960	Tract # 1947	
<b>Total Acres:</b>	160.31	<b>Cropland Acres:</b> 154.72
<b>Corn Base Acres:</b>	<b>76.5</b>	<b>Soy Base Acres:</b> <b>76.5</b>
<b>Farm Program:</b>	Corn: PLC Beans: ARC-County	
Price Loss Coverage PLC Yields		
<b>Corn Yield:</b>	175	<b>Soybean Yield:</b> 57

### Real Estate Tax Information

Parcel ID #	Acres	2021 Assessed Value	2020 Taxes Payable 2021
03-08-01-100-001	162.1	\$ 95,880.00	\$5,851.94

### Yield History

	Corn	Soybeans
<b>2021</b>	248	83
<b>2020</b>	236	68
<b>2019</b>	214	59
<b>2018</b>	257	83
<b>2017</b>	240	73

### 2020/2021 Soil Test Data

pH: 6.1 P1: 42.5 K: 306

# Farm for Sale

Plat Map

EAST PART BUCKHART

Refer to page 61 for keyed parcels

T.14N.-R.3-2W.

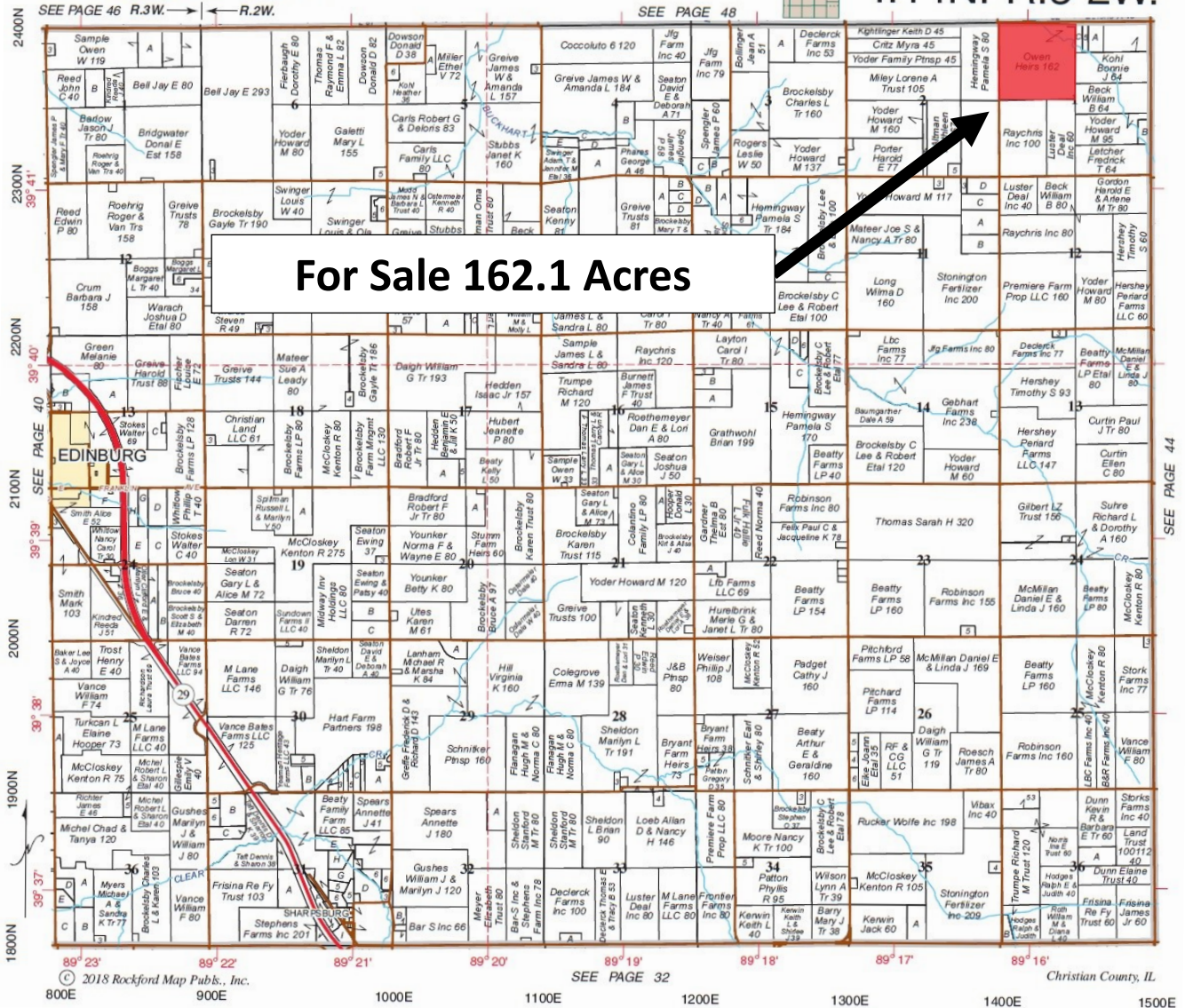

**For Sale 162.1 Acres**

Reprinted with permission of Rockford Map Publishers, Inc.



Licensed Real Estate Broker Corporation

**Seth Melton, Listing Broker**  
**Alex Rhoda, Broker**  
**Corey Zelhart, Broker**  
**Steve Myers, Managing Broker**

**Phone 217-425-4541**  
**Phone 217-425-8821**  
**Phone 217-425-8245**  
**Phone 217-425-8340**

**Disclaimer:** The information contained in this brochure is considered accurate. It is subject to verification and no liability for errors or omissions is assumed. There are no warranties, expressed or implied, as to the information herein contained, and it is recommended that an independent inspection of the property be made by all buyers.  
**Agency:** Busey Farm Brokerage, a division of Busey Bank, its agents and representatives, are agents of the Seller

# Farm for Sale

## Aerial Map and Soil Information

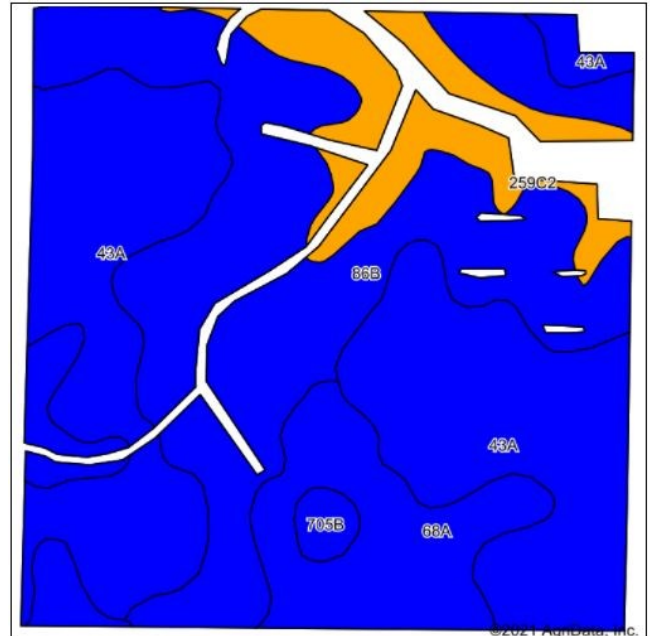

Area Symbol: IL021, Soil Area Version: 14							
Code	Soil Description	Acres	Percent of field	Il. State Productivity Index Legend	Corn Bu/A	Soybeans Bu/A	Crop productivity index for optimum management
43A	Ipava silt loam, 0 to 2 percent slopes	59.03	39.3%		191	62	142
**86B	Osco silt loam, 2 to 5 percent slopes	53.94	35.9%		**189	**59	**140
68A	Sable silty clay loam, 0 to 2 percent slopes	22.12	14.7%		192	63	143
**259C2	Assumption silt loam, 5 to 10 percent slopes, eroded	13.64	9.1%		**152	**48	**111
**705B	Buckhart silt loam, 2 to 5 percent slopes	1.63	1.1%		**188	**60	**141
<b>Weighted Average</b>					<b>186.9</b>	<b>59.8</b>	<b>138.6</b>

Table: Optimum Crop Productivity Ratings for Illinois Soil by K.R. Olson and J.M. Lang, Office of Research, ACES, University of Illinois at Champaign-Urbana. Version: 1/2/2012 Amended Table S2 B811

Crop yields and productivity indices for optimum management (B811) are maintained at the following NRES web site:

<http://soilproductivity.nres.illinois.edu/>

\*\* Indexes adjusted for slope and erosion according to Bulletin 811 Table S3



Licensed Real Estate Broker Corporation

**Seth Melton, Listing Broker**  
**Alex Rhoda, Broker**  
**Corey Zelhart, Broker**  
**Steve Myers, Managing Broker**

**Phone 217-425-4541**  
**Phone 217-425-8821**  
**Phone 217-425-8245**  
**Phone 217-425-8340**

**Disclaimer:** The information contained in this brochure is considered accurate. It is subject to verification and no liability for errors or omissions is assumed. There are no warranties, expressed or implied, as to the information herein contained, and it is recommended that an independent inspection of the property be made by all buyers.  
**Agency:** Busey Farm Brokerage, a division of Busey Bank, its agents and representatives, are agents of the Seller